

CAP. WITH SCREW PLUG TERMINALS 21 POLE

Use with MVP12 / Exact12 UNIVERSAL

Cap for 4-way distribution box, UNIVERSAL, 5-pole
Plastic housings with good resistance against chemicals and oils.
The resistance to aggressive media should be individually tested for your application. Further details on request.

Link to Product

Illustration

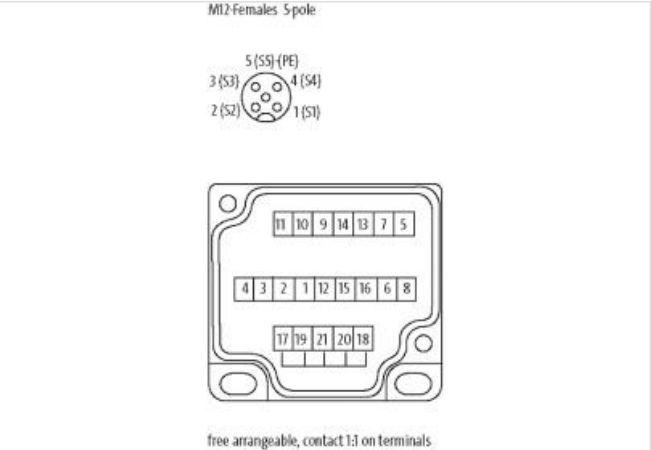
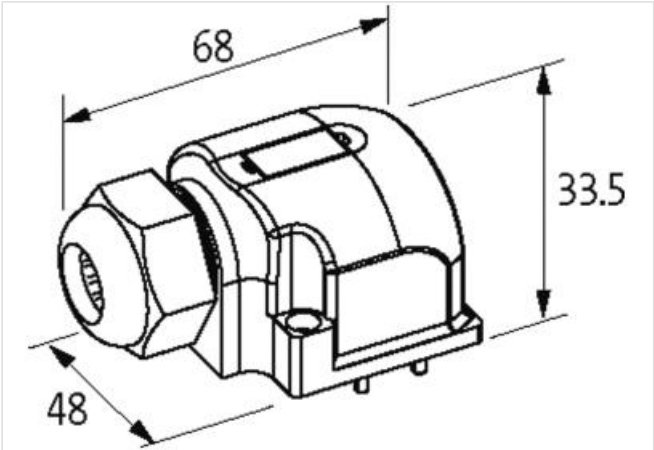

Product may differ from Image



Commercial data	
ECLASS-6.0	27143423
ECLASS-6.1	27279219
ECLASS-7.0	27279219
ECLASS-8.0	27279219
ECLASS-9.0	27440108
ECLASS-10.1	27440111

ECLASS-11.1	27440111
ECLASS-12.0	27440111
ETIM-5.0	EC002585
customs tariff number	85366990
GTIN	4048879378536
Packaging unit	1
Electrical data Supply	
Total current max.	8 A
Installation	
Connection cross section max.	1,5 mm ²
AWG number max.	16
Installation Connection	
Connection	Screw plug-in terminals
Device protection Media	
Flame resistance	flame retardant
Mechanical data Material data	
Material housing	Plastic
Environmental characteristics Climatic	
Operating temperature min.	-20 °C
Operating temperature max.	80 °C
Connection type 2	
Family construction form	Cap
No. of poles	21
Family construction form	M12
Gender	female
Color contact carrier	black
Coding	A
No. of poles	5